



Walchand College of Engineering

Vishrambag, Sangli

(Government Aided Autonomous Institute)

Planning and Development Cell

TENDER DOCUMENT



Tender for Renovation of CCF for Seminar Hall at Computer Department

Tender is available on website -

<https://organizations.maharashtra.nextprocure.in>

Date of releasing tender: 02nd February 2024

Last date of submission of tender: 12th February 2024 up to 01:30 pm

Date of opening of technical tender document: 12th February 2024 at 03:30 pm

Date of opening commercial tender document: 13th February 2024 at 11:00 am



INVITATION FOR TENDERS

Ref No: WCE/PD/COMP/2024/

Date: 02/02/2024

To _____

SUB: Invitation of Tender for Renovation of CCF for Seminar Hall at Computer Department

Dear Sir,

You are invited to submit your most competitive bid subject to the terms and conditions as enclosed herewith. Tender form is available on the website "<https://organizations.maharashtra.nextprocure.in>" for the submission. To participate, bidders need to register themselves on the portal and generate user ID and Password. For any queries registered bidders may write to stores@walchandsangli.ac.in , ecac@walchandsangli.ac.in The cost of tender form (Rs 5000/-) and EMD of Rs.40000/- is to be paid. The bidders may pay the amount through **NEFT** on Bank of India (Vishrambag Branch); Current account 150720100000002; IFSC: BKID0001507 with narration as "amount towards cost tender form and EMD of the tender -----". A photocopy of the **NEFT** needs to be uploaded on the portal along with the offer.

Please note that the last date for E - submission of the Tender is 12th February 2024. The tenders without Cost of tender form and EMD will not be considered. The services are to be provided within our college premises within 04 days from the date of our firm purchase order.

We look forward to receive your most competitive bids.

Yours faithfully,

Director

Walchand College of engineering
Vishrambag, Sangli.



Eligibility Criteria

The Applicants / Bidder shall fulfill all of the following eligibility criteria independently, as on the date of Submission of the bid.

Eligibility Criteria	
1.	The Applicants / Bidder may be a Proprietary firm /Partnership firm / Limited Company / Corporate body legally constituted etc.
2.	There should be no case pending with the police case against the Proprietor/Firm/Partner or the Company as a whole (Applicants / Bidder) shall not have been blacklisted by any Government Departments, Public Sector Companies, Banks and Government Autonomous organizations.
3.	The Applicants / Bidder should be registered with PWD or equivalent, Income Tax and GST Tax
4.	Experience/ Work done Certificate: The Bidder Should have Completed successfully at least one similar type of work.

TERMS AND CONDITIONS

Please note following terms and conditions before filling the tender form and return this sheet duly signed along with company's seal.

- The TENDER is not transferable and the cost of the TENDER document is Rs.5000/- (This amount is non-refundable). The scan copy of online payment of RS.5000/- for cost of tender from and EMD of Rs. **40000/-** must be uploaded. Online payment should be issued in favor of, Director, Walchand College of Engg., Sangli.
- The Contractor / Bidder must visit to the site, mention in above tender work and same site visit form duly signed by Engineer In-charge should upload with the documents.
- The bidder shall upload documents showing qualification information, as follows
 - Total monetary value of each work performed for each year of the last 3 years, exceeding estimated cost of present work.
 - Income tax clearance certificate from the concerned IT circle or IT Return forms;
 - GST Registration certificate.
 - Details of any litigation, in which the bidder is involved, the concerned parties and disputed amount in each case.
- Bid Price**
 - The contract shall be for the full work as described above. Corrections, if any, shall be made by crossing out, initializing, dating and re writing in words.
 - All duties, taxes, GST and other levies etc. as applicable are payable by the bidder under the contract and shall be included in the total price.**
 - The rates quoted by the Bidder shall be fixed for the duration of the contract and shall not be subject to adjustment on any account.
 - The prices should be quoted in Indian Rupees only.
- Each Bidder shall submit only one tender for this work.
- Validity of Tender**

Tender offer shall remain valid for 15 days after the deadline date specified for submission.
- Evaluation of Tenders**

The Owner will evaluate and compare the Tenders determined to be substantially responsive i.e. which contains items in (a) and satisfies (b), (c), and (d) as follows....



- a) Conform to the terms and conditions, and specifications
 - b) Evaluation and Comparison of bids shall be done on Total price including charges like transportation, freight and insurance, commissioning, GST, any other installation/fixing etc.
 - c) Any conditional Tender will not be accepted and quantity of the items may vary as per requirement at the time of execution of the work.
- 8 The Owner will award the contract to the Bidder whose Tender has been determined to be substantially responsive as per the terms and conditions.
- 9 Notwithstanding the above, the Owner reserves the right to accept or reject any Tenders and/or to cancel the bidding process and/or reject all Tenders at any time prior to the award of contract.
- 10 **The duration of work is 45 days from the date of Work order. The penalty for the delay in proportion to the cost of work, but minimum at Rs. 2000/- per day will be charged.**
- 11 Payment will be made 95 % after completion of work satisfactorily and 5% will be kept as security period of one year.
- 12 In case of dispute, persons appointed by WCE will act as Conciliator. All legal disputes are subject to the Jurisdiction of Sangli court only.
- 13 **Rights to change quantity, any clause fully or partially in the terms and conditions mentioned above and right to cancel any tender without giving any reason is reserved with Director, Walchand College of Engineering, and Sangli.**

Director
Walchand College of Engineering
Vishrambag, SANGLI 416 415
Tel. No. 0233-2300383
Fax No. 0233-2300831



Special Terms and Conditions

1. In no case, the tenderer will be exempted from paying E.M.D. If SSI/MSME registered agency found to be lowest the agency has to accept work/purchase order (WO/PO) and meet with scope of the WO to the satisfaction of college authority.
2. If the bidder fails to meet with scope of the tender, the college keeps right to convey the same to appropriate agency to take suitable legal action and even blacklisting the agency for all the future dealings with the college.
3. The right to reject or accept any or all offers with or without modifications from any or all parties without assigning any reason is reserved with the "Director, Walchand College of Engineering, Sangli".
4. Enough supporting documents, for example, photograph of the work, specifications of the items, customer list, Authorization letter, GST number etc. must be submitted along with the TENDER.
5. Detailed CPM chart for the various work/activities to be submitted in the tender document. Bidder should carefully note the cut-off dates for carrying out whole work.
6. Every effort is being made to keep the website up to date and running smoothly 24 x 7 by the Walchand College of Engineering Sangli. However, Walchand College of Engineering takes no responsibility and will not be liable for the website being temporarily unavailable due to any technical issue at any point of time.
7. Walchand College of Engineering, Sangli will not be liable or responsible for any damages or expenses arising from any difficulty, error, imperfection or inaccuracy with this website. It includes all associated services or due to such unavailability of the website or any part thereof or any contents or any associated services.
8. Tenderers must register, pay the necessary fees, and follow the time table of e-tendering process and get their activities of e-tendering processes done well in advance so as to avoid any inconvenience due to unforeseen technical problem if any.
9. Walchand College of Engineering Sangli will not be responsible for any incomplete activity of e-Tendering process of the tenderer due to technical error / failure of website and it cannot be challenged by way of appeal, arbitration and in the Court of Law.
10. The bidder has to submit an undertaking for terms and conditions, if selected for placing the order (Undertaking form will be provided after shortlisting).
11. **It is mandatory for successful bidder, to submit receipts for GST paid on RA Bills. Failure to this, the final bill will not be paid until submission of the receipts. Further right to retain appropriate amount is reserved by the college in order to ensure and verify payment of GST applicable for the work under consideration. However, due payment of all taxes including GST is sole responsibility of the bidder.**

Declaration:

I / We have read the above instructions carefully, and I /we abide by the instructions.

Sign, Stamp and Name of the Bidder

Date:



Work Description

Tender for Renovation of CCF for Seminar Hall at Computer Department

Sr. No.	Item/Specification	Qty.	Unit	Rate (Rs.)	Amount (Rs.)
1	Removing existing ceiling, flooring, electrification and misc material and stacking at suggested location etc complete as directed by engineer incharge	1	Job	20000	20000.00
2	Providing and constructing AAC light weight block masonry in adhesive etc complete as directed by engineer incharge	15.788	Cum	8500	134198.00
3	Providing and applying 50 mm thick Plain cement concrete 1:2:4 over the masonry with neat cement float, curing agent at specified rate etc complete as directed by engineer incharge	5.133	Cum	8500	43630.50
4	Providing and fixing Aluminium partition in Zindal sections, 4 mm thick plain glass for door and remaining all in laminated Particle board etc complete as directed by engineer incharge	74.30	Sqm	2500	185750.00
5	Providing and fixing 8-12 mm thick Gypsum/light weight acoustic board to Aluminium partition/Wall with 4 mm thick Nonwoven carpet of approved colour , wooden battens at 1 m c/c to wall and GI straps at 0.6 m c/c on Aluminium partition, adhesive, screws, teak wood battens/bead with two coats of melamine polish as per design etc complete as directed by engineer incharge	344.80	Sqm	1650	568920.00
6	Providing and fixing Computer counters 0.45 m wide with four vertical supports of 36 mm thickness, Footrest facility all work in 18 mm thick waterproof plywood and 1 mm thick approved laminate, necessary wire way and raceway with 0.15 m height at bottom as per design and drawing, unexposed area to be covered with white laminate etc as per design and drawing complete as directed by engineer incharge. (Some counters will be movable)	69.75	m	4000	279000.00
7	Providing and fixing Computer counters 0.60 m wide with vertical supports of 36 mm thickness, keyboard drawer and plank to keep CPU, Footrest facility, all work in 18 mm thick waterproof plywood and 1 mm thick approved laminate, necessary wire way and raceway with 0.15 m X 0.075 m wide at top, unexposed area to be covered with white laminate, etc as per design and drawing complete as directed by engineer incharge. (Some counters will be movable)	39.20	m	5500	215600.00



Sr. No.	Item/Specification	Qty.	Unit	Rate (Rs.)	Amount (Rs.)
8	Providing Maxan/Parin or equivalent make auto tip up Medium back chairs with handle, fabric with foam to seat and back etc as per attached photograph (Approval need to be taken from authority for this item) etc complete as directed by engineer incharge	90	No	3500	315000.00
9	Providing Parin or equivalent make Medium back non-revolving chairs with handle, with SS pipe or flat Frame, foam with approved fabric to seat and back (Approval need to be taken from authority for this item) etc as per sample present on site etc complete as directed by engineer incharge	40	No	4500	180000.00
10	Providing and fixing Kajaria or equivalent make Vitrified tile flooring of 600 X 600 mm size in MYK Laticrete Chemical, spacers at 1.2 m c/c, acid wash and filling tile coloured grout etc complete as directed by engineer incharge	106.3	Sqm	1100	116930.00
11	Providing and fixing suspended ceiling in acoustic mineral and Gypsum sheets of 600X600 mm size, 8 to 10 mm thick with GI straps and wires, TEES and side angles, job in true line and level etc complete as directed by engineer incharge	233.3	Sqm	850	198305.00
12	Providing and fixing non-woven carpet 4 mm thick of approved colour to floor and furniture with adhesive and teak wood battens as per design and drawing etc complete as directed by engineer incharge	242.12	Sqm	400	96848.00
13	Providing and fixing 600X600 mm LED fitting in ceiling etc complete etc complete as directed by engineer incharge	24	No	4000	96000.00
14	Providing and fixing circular or square LED ceiling/wall lights, 30 watts etc complete as directed by engineer incharge	24	No	650	15600.00
15	Providing and fixing circular or square LED ceiling/wall lights, 20 watts etc complete as directed by engineer incharge	12	No	450	5400.00
16	Providing Concealed Electrical Point wiring in 1.5 Sqmm wires with Polycab or equivalent make wires and Anchor or equivalent make switches, plugs, MCCB, RCCB with all accessories etc complete as directed by engineer incharge	360	No	850	306000.00
17	Providing Concealed Electrical power Point wiring in 4 Sqmm wires with Polycab or equivalent make wires and Anchor or equivalent make switches, plugs, MCCB, RCCB with all accessories etc complete as directed by engineer incharge	10	No	1200	12000.00
18	Providing and fixing Bajaj or equivalent make Ceiling fans 1200 mm size with regulator and all accessories and fasteners etc complete as directed by engineer incharge	18	No	2750	49500.00



Sr. No.	Item/Specification	Qty.	Unit	Rate (Rs.)	Amount (Rs.)
19	Providing and fixing Aluminum sliding window of two tracks with mosquito net and Granite frame all around by removing shutters of old MS window etc complete as directed by engineer incharge	3.6	Sqm	3800	13680.00
20	Providing and applying two coats of Luster paint, preparing the surface by scrapping wall surface, applying two coats of putty and one coat of lambi and primer etc complete as directed by engineer incharge	294.10	Sqm	220	64702.00
21	Providing and applying two coats Apex paint over the one coat of primer, scrapping the wall surface filling cracks and voids with external putty etc complete as directed by engineer incharge	895.00	Sqm	180	161100.00
22	Providing and fixing American folded curtains with rods to windows and doors as per approved fabric sample etc complete as directed by engineer incharge	30.60	Sqm	950	29070.00
23	Providing and fixing 1.5 Tone capacity Air conditioners of Voltas or equivalent make with necessary brackets and indoor and outdoor unit with testing commissioning etc complete as directed by engineer incharge	12	No	65000	780000.00
24	Providing and fixing faculty table 0.75 m wide "L" Shape with vertical supports and edges of 36 mm thickness, keyboard drawer and plank to keep CPU, Footrest facility, all work in 18 mm thick waterproof plywood and 1 mm thick approved laminate, necessary wire way and raceway with 0.15 m X 0.075 m wide at top with 300 mm plain diamond polished glass, unexposed area to be covered with white laminate, etc as per design and drawing complete as directed by engineer incharge.	7.2	m	6000	43200.00
25	Providing and fixing conference table 1.20 m wide with vertical supports and edges of 36 mm thickness, Footrest facility, all work in 18 mm thick waterproof plywood and 1 mm thick approved laminate, necessary wire way and raceway with 0.15 m X 0.075 m wide at bottom unexposed area to be covered with white laminate, etc as per design and drawing complete as directed by engineer incharge.	4	m	6500	26000.00



Sr. No.	Item/Specification	Qty.	Unit	Rate (Rs.)	Amount (Rs.)
26	Providing repairs to existing door by providing 6 mm thick plywood bead and 1 mm thick approved laminate etc complete as directed by engineer incharge	12.01	Sqm	1550	18615.50
Total cost of works Rs.					3975049.00

We agree to execute the above work in accordance with specifications and drawing as directed by engineer-in-charge in total price (including GST) at % above/below i.e. for Rs..... In words Within the period specified in the tender form.

Date

Signature of Bidder

Stamp

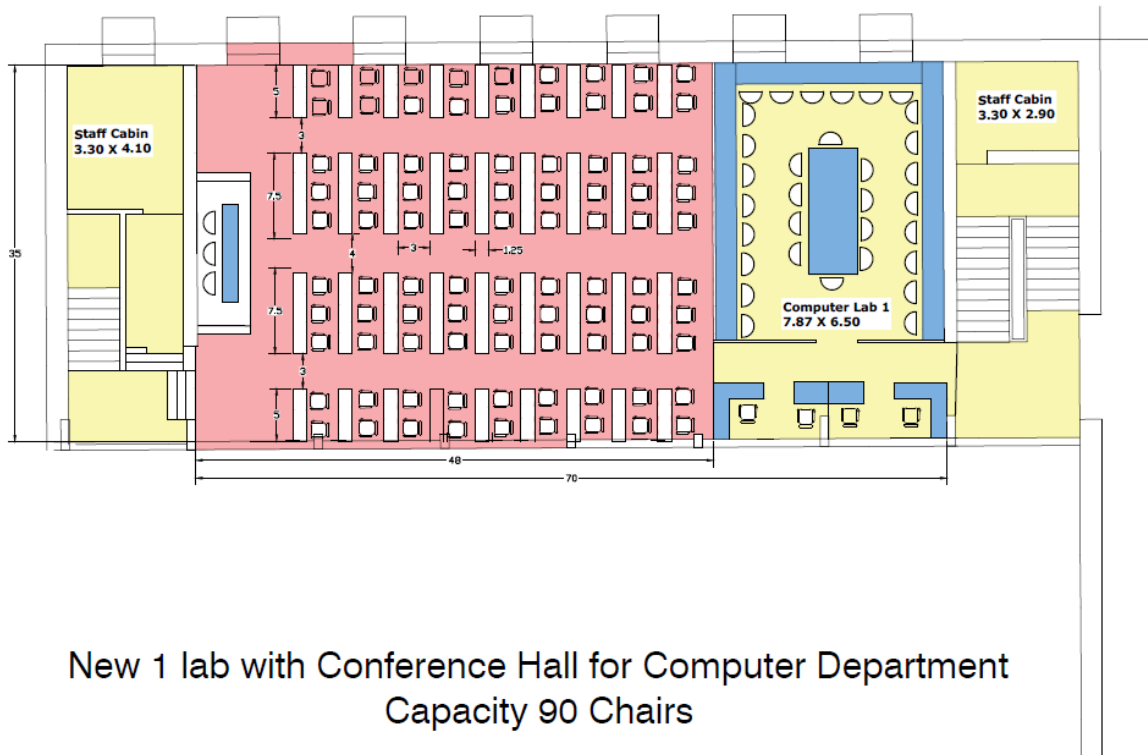



Auto tip up Medium back chairs (Not fixed to Floor)



Medium back non-revolving chairs with handle, with SS pipe

